

Installation Instructions

Cabin Filter

Instrucciones de montaje

Filtro de habitaculo

Notice de montage

Filtre d'habitacle

C35520C

LOCATION: BEHIND THE GLOVE COMPARTMENT*

QUANTITY USED: 2

DEGREE OF DIFFICULTY: MODERATE

ESTIMATED INSTALLATION TIME: 24 MINUTES

Mercedes-Benz 1996-2002 E Class & 2000-06 CL & S Class

NOTE: Obtain the radio anti-theft code prior to disconnecting the battery ground cable.

1. Open the hood and disconnect the battery ground cable.
2. Remove the glove compartment retaining screws, then the glove compartment, Figure 1.
3. Remove the cabin filter cover through the glove compartment opening, Figure 2.
4. Remove the cabin air filter element from the filter housing, Figures 3 & 4.
5. Install the new cabin air filter into the filter housing, Figure 5.
6. Install the cabin air filter cover. Ensure the cover is properly seated.
7. Install the glove compartment, Figure 6.
8. Connect the battery ground cable, then enter the radio anti-theft code.

⚠ WARNING	
STOP	Turn The Engine Off Failure to do so may cause electrocution, burns and severe injury.

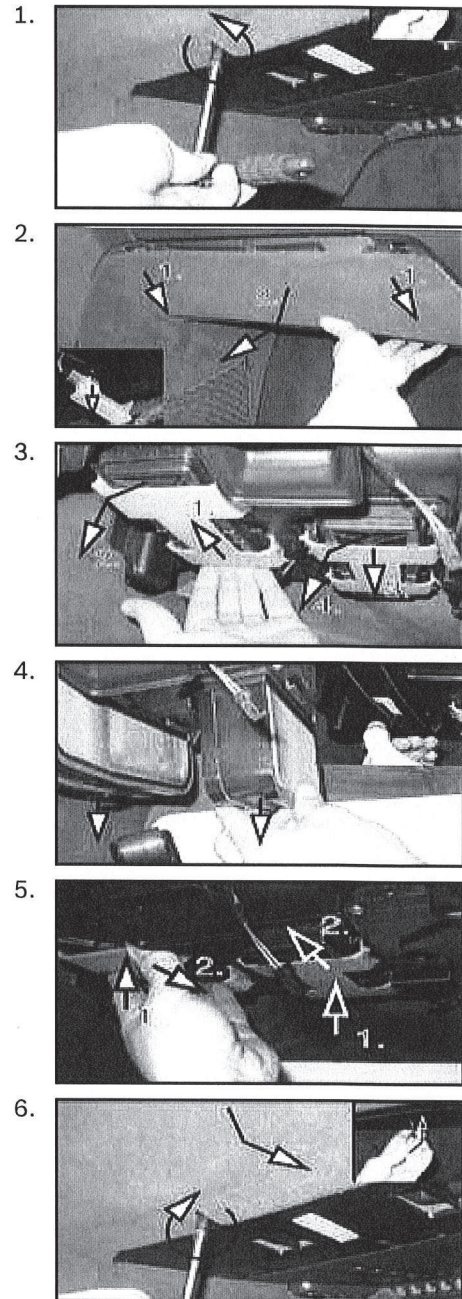

*Instructions may vary by make, model and year.